

ADDENDUM 4
RESCUE 8 STATION
Dated; 11-9-16

Requests for Information

BID OPENING DATE:

Bid opening date has been changed to November 14, 2016 at 3:00 PM.

Question 19:

Does it have an existing sprinkler system? To be renovated/added on to?

Sheet CS.2 states: sprinklered required: yes provided: yes

If no existing, do they want it sprinklered?

Nothing in specs or civil/mech/plumb drawings show it either way. (That I could find)

Answer: There will be no Sprinkler system in this building. The Sprinkler not on drawing CS-2 shall be revised to read, Sprinkler System – Required- No; Provided- No.

Question 20:

(Drawing: Sheet ID.1)

Please indicate Silestone Color to be used.

Answer: There will be two Silestone colors in this project:

- a. SF-1 to be used in Kitchen Counters. The color would be “COFFEE BROWN.”
- b. SF-2 to be used in Vanities at room 204 and 210. The color would be, “SIENNA RIDGE 08.”

These finishes have been added to the project on the finish schedule ID.1. See attached sketch ASK-3.

A detail for the vanity counter has been added to the project (18/A6.1). See attached sketch ASK-2.

Drawing Revision

Drawing P-1- Plumbing Cover Sheet:

Plumbing Fixture Connection Schedule- LAV-2 shall be changed to an under-mount sink.

Specifications Revisions

Specifications Section 15150:

Page 4, Par. 3.3 – B, Shall be changed to say, Contractor to provide either the cast iron or schedule 40 PVC piping.

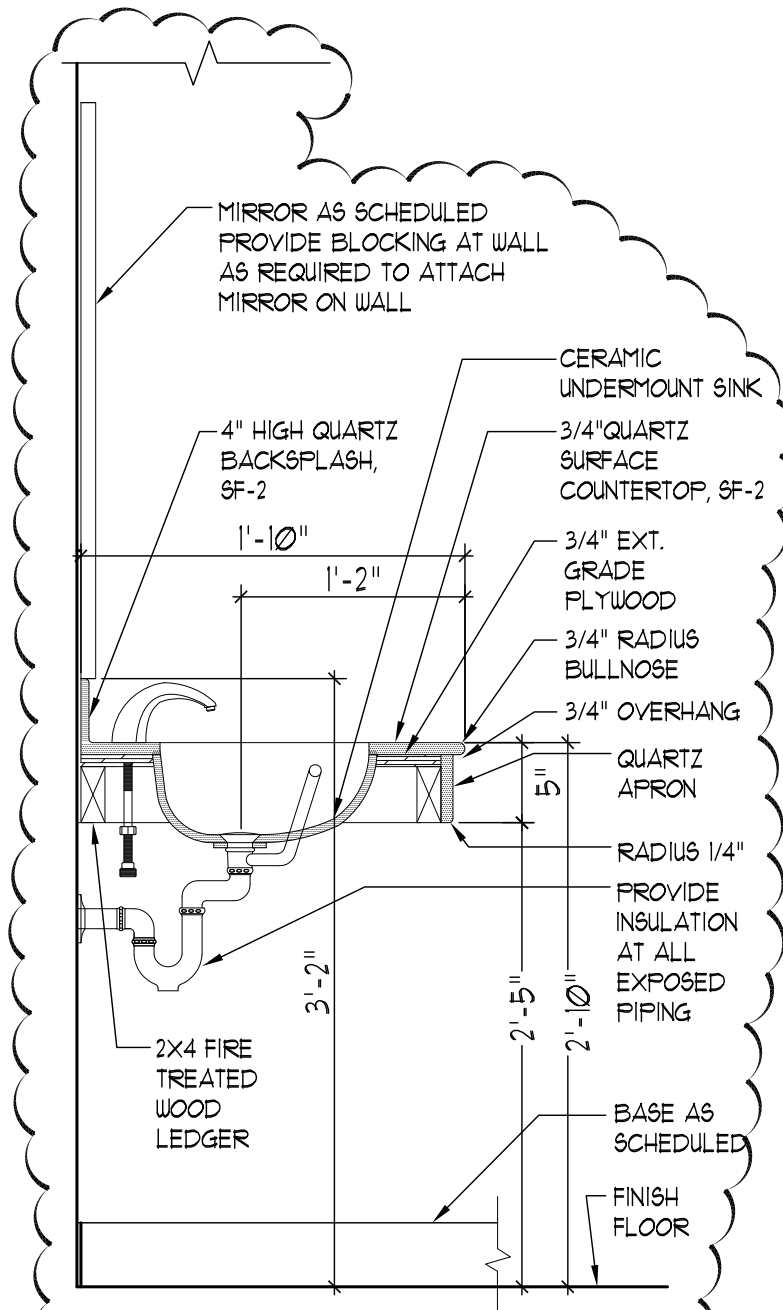

18 SECTION @ VANITY

A6.1 SCALE: 1"=1'-0"

@ TOILETS 204 AND 210



4031 University Drive, Suite 120, Fairfax, VA, 22030
Telephone: (703)352-1933 Fax: (703)691-9171

PROJECT NAME: RESCUE 8
PROJECT NO.: 15115
DESIGNED: AI
REFERENCE SHEET: A6.1

SUBJECT: COUNTERTOP FINISHES
DATE: 11-08-16
SHEET 1 OF 2

ASK
2

FILE: .

FINISH INDEX

	ITEM	DESCRIPTION	MANUFACTURER	COLOR/ REMARKS
SOLID SURFACE	LOCKER)			
	PL-1 (DAY RM, KIT)	LAMINATE CABINET	WILSONART	WILD CHERRY 1054-60
	SF-1 (KITCHEN)	SILESTONE COUNTERTOP	CONSENTINO	COFFEE BROWN
	SF-2 (TOILETS 204/210)	SILESTONE COUNTERTOP	CONSENTINO	SIENNA RIDGE 08

NOTES:
 1. PROVIDE MOLD & MOISTURE RESISTANT GYP. BD. @ WET AREAS (LOCKERS AND TOILET, JANITOR'S CLOSET AND SO ON)
 2. SEE DORO SCHEDULE FOR LOCATION

3. ACCEPTABLE MANUFACTURER: INPRO® CORPORATION, PO BOX 406 MUSKOGEE, ALABAMA 36455
 TELEPHONE: 800.222.5556, FAX: 888.715.8401, INPROCORP.COM
 WALL PANELS: SQUARE EDGE. PROVIDE 1/2" THICK BIOPRISM® SOLID SURFACE PATTERN. EACH SHOWER STALL SHALL HAVE ONE SMALL SOAP SHELF, DSSHP
 MOLDINGS: BIOPRISM® SOLID SURFACE INSIDE CORNER MOLDING, DSCIP196, IS



4031 University Drive, Suite 120, Fairfax, VA, 22030
 Telephone: (703)352-1933 Fax: (703)691-9171

PROJECT NAME: RESCUE 8
 PROJECT NO.: 15115
 DESIGNED: AI
 REFERENCE SHEET: ID.1

SUBJECT: COUNTERTOP FINISHES
 DATE: 11-08-16
 SHEET 2 OF 2

ASK
 3